

DRAGON SCREEN

Quilt Design by Linda Fitch Featuring fabrics from the Bali Handpaints Collection by Hoffman California Fabrics

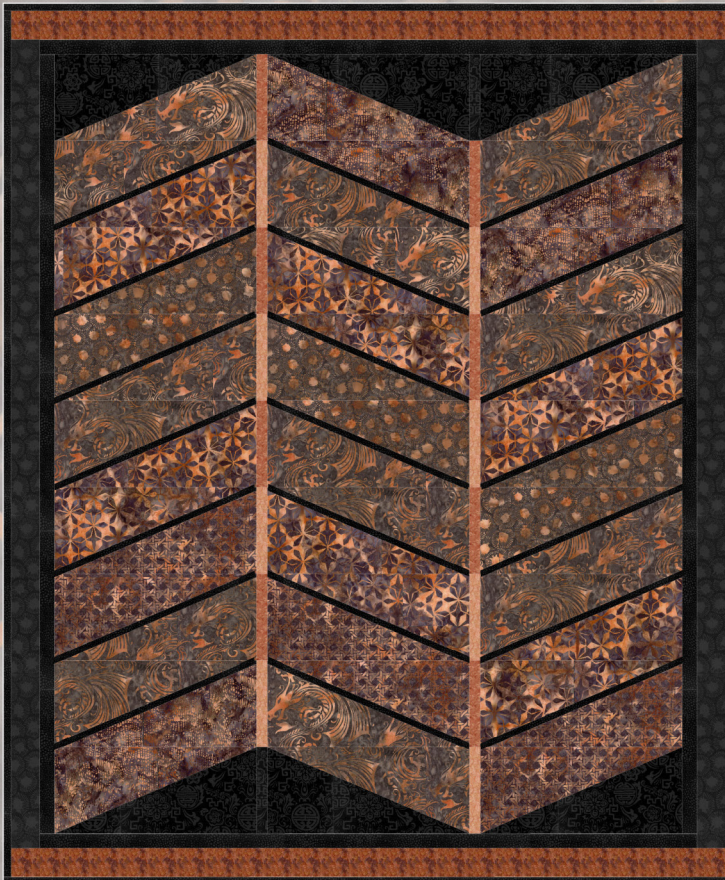

To see more quilts designed by Linda go to www.hoffmanfabrics.com

Free pattern available from
www.HoffmanFabrics.com

Quilt Size 50 1/2" x 61"

| Style | |
|--------------------|-------------|
| K2476 #494 Raven | 3/8 yard |
| K2478 #584 Granite | 1 yard |
| K2484 #172 Copper | 3/8 yard |
| K2485 #172 Copper | 5/8 yard |
| K2486 #584 Granite | 3/8 yard |
| K2487 #494 Raven* | 1 1/2 yard* |
| K2490 #584 Granite | 3/8 yard |
| K2490 #494 Raven | 3/8 yard |
| 1895 #567 Cider | 1/8 yard |
| 1895 #168 Nutmeg | 3/8 yard |
| 1895 #39 Rust | 1/8 yard |

Note: These are estimated yardages. Final yardages will be on pattern.

*Yardage includes binding.

BACKING: Coordinate of your choice. 4 yards (1 kit); 48 yards (12 kits)

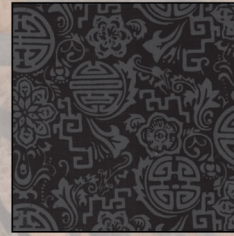

K2476 #494 Raven



K2478 #584 Granite

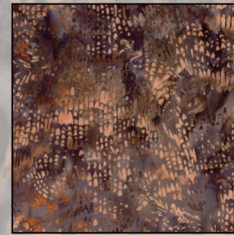

K2484 #172 Copper



K2485 #172 Copper



K2486 #584 Granite

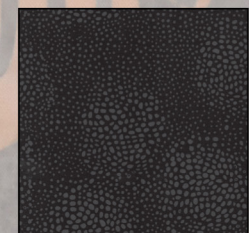

K2487 #494 Raven

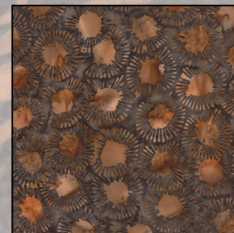

K2490 #584 Granite



K2490 #494 Raven

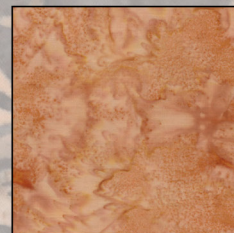

1895 #567 Cider

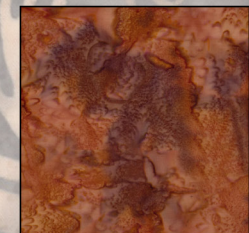

1895 #168 Nutmeg

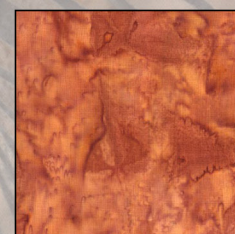

1895 #39 Rust

HOFFMAN FABRICS
CALIFORNIA-INTERNATIONAL

DRAGON SCREEN

Quilt Design by Linda Fitch for Hoffman CA Fabrics
Featuring Hoffman Bali Batiks Released at Fall 2012 Quilt Market
51" x 61"

| | | | | | |
|----------|-------|-------------|----------|-------|------------|
| Fabric A | K2478 | 584-Granite | Fabric G | K2487 | 494-Raven |
| Fabric B | K2485 | 172-Copper | Fabric H | K2490 | 494-Raven |
| Fabric C | K2490 | 584-Granite | Fabric I | 1895 | 168-Nutmeg |
| Fabric D | K2486 | 584-Granite | Fabric J | 1895 | 567-Cider |
| Fabric E | K2484 | 172-Copper | Fabric K | 1895 | 39-Rust |
| Fabric F | K2476 | 494-Raven | | | |

Cutting

Fabric A-cut five-5 3/4th's x WOF (extra fabric is included for fussy cutting) Sub-cut 6 pieces using Parallelogram template 1. Sub-cut 3 pieces using Parallelogram template 2.

Fabric B-cut three-5 3/4th's x WOF. Sub-cut 4 Pgram 1...and 2 of Pgram 2.

Fabric C-cut two-5 3/4th's x WOF. Sub-cut 2 Pgram 1...and 1 of Pgram 2.

Fabric D-cut two-5 3/4th's x WOF. Sub-cut 2 Pgram 1 and 2 of Pgram 2.

Fabric E-cut two-5 3/4th's x WOF. Sub-cut 2 Pgram 1 and 1 using Pgram 2.

Fabric F-cut four-5 3/4th's x WOF. Sub-cut 4 Pgram 1 and 2 from Pgram 2. Cut two-1 1/4" x 6 1/2" pieces.

Fabric G-Cut eleven-1" strips. Sub-cut into 21-16" strips. Cut five-1 1/2" strips WOF for inner border. Cut 6 strips at

2¼" (WOF) for binding.

Fabric H- Cut three-2½" x WOF for left and right borders.

Fabric I- Cut three-2½"x WOF for top and bottom borders.

Fabric J- Cut two-1¼" strips. Sub-cut 8-1 ¼" x 6 ½" pieces for vertical sashing.

Fabric K- Cut two-1¼" strips. Sub-cut 8-1 ¼" x 6 ½" pieces for vertical sashing.

Quilt Assembly

Use Dragon Screen Fabric Diagram or the photo for the print layout.

Stitch left column interspersing Fabric G strips between the Pgram shapes.

End the top and bottom of left column with Fabric F Pgram 1. Do not trim (yet) extra fabric. Repeat for right column. Repeat for middle column, however, use Pgram 2 for top and bottom.

Piece Fabrics J & K 1 ¼ x 6 ½" pieces together at short ends, alternating the colors. Include the 2 Fabric F pieces at the appropriate places. Refer to the photo for correct rotation.

Sew left side of the pieced sashing to the right of the left column. Sew the middle column to right side of the pieced sashing. Try to center the seam where the two colors of sashing meet, to the middle of the black sashing.

Continue to sew the left sashing to the right side of the middle column, again matching the seam to the middle of

each black sashing strip. Sew the right column to the sashing, again matching the seam to the middle of the black sashing.

Now is the time to trim the excess fabric (F) for a straight edge on top and bottom.

Piece the five-1 1/2" Fabric G strips at the short ends. Measure the quilt length (down the middle) and cut 2 lengths of this measurement. Sew 1 length to the left and right sides.

Measure the width of the quilt and cut 2 strips to this measurement. Sew 1 strip to the top and 1 to the bottom.

Do the same for the outer borders, using Fabric H for left and right outer borders and Fabric I for top and bottom.

Layer, quilt, bind and enjoy!

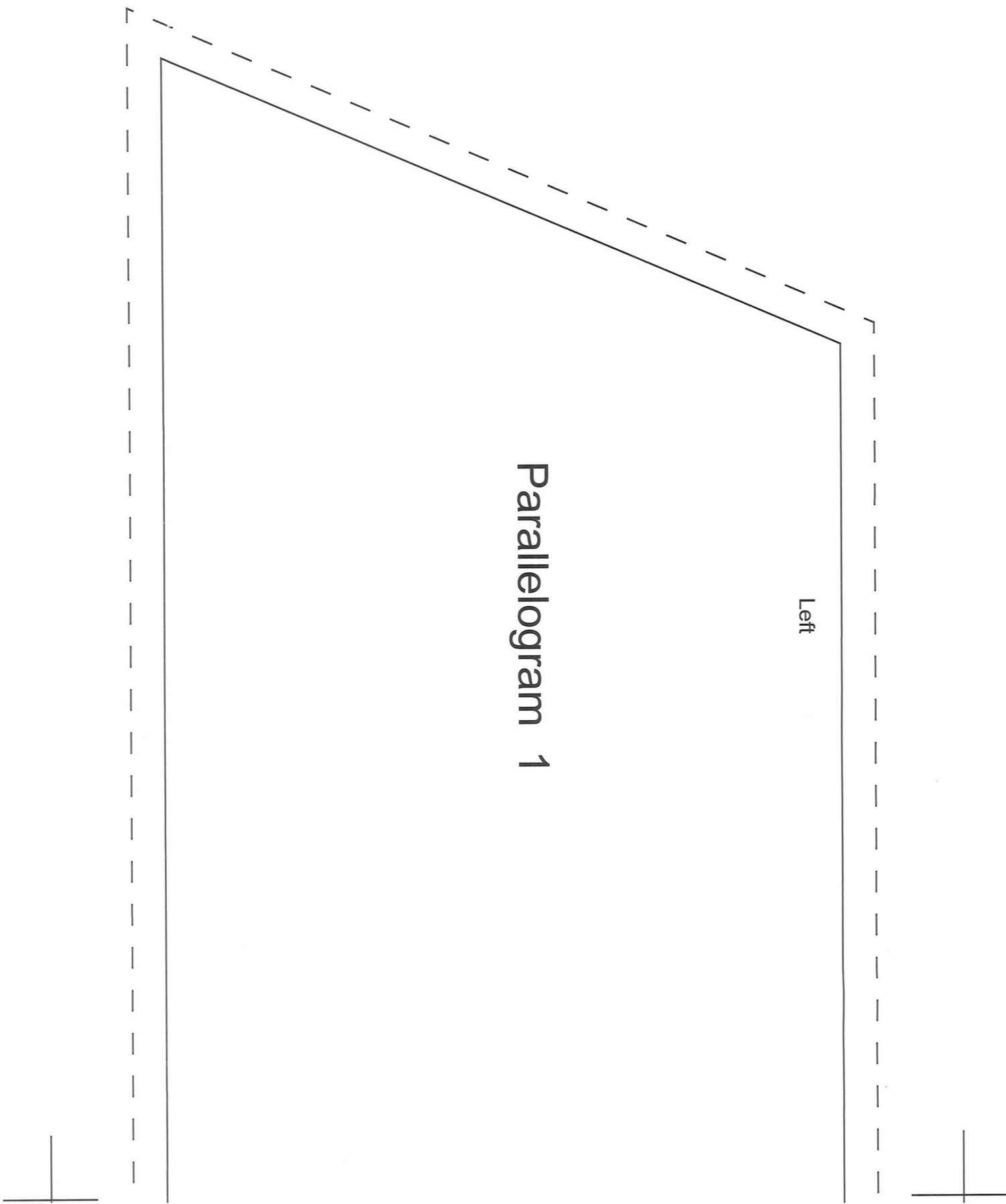

Print out template and piece together for actual size. Line up halves to complete parallelogram 1 and parallelogram 2.

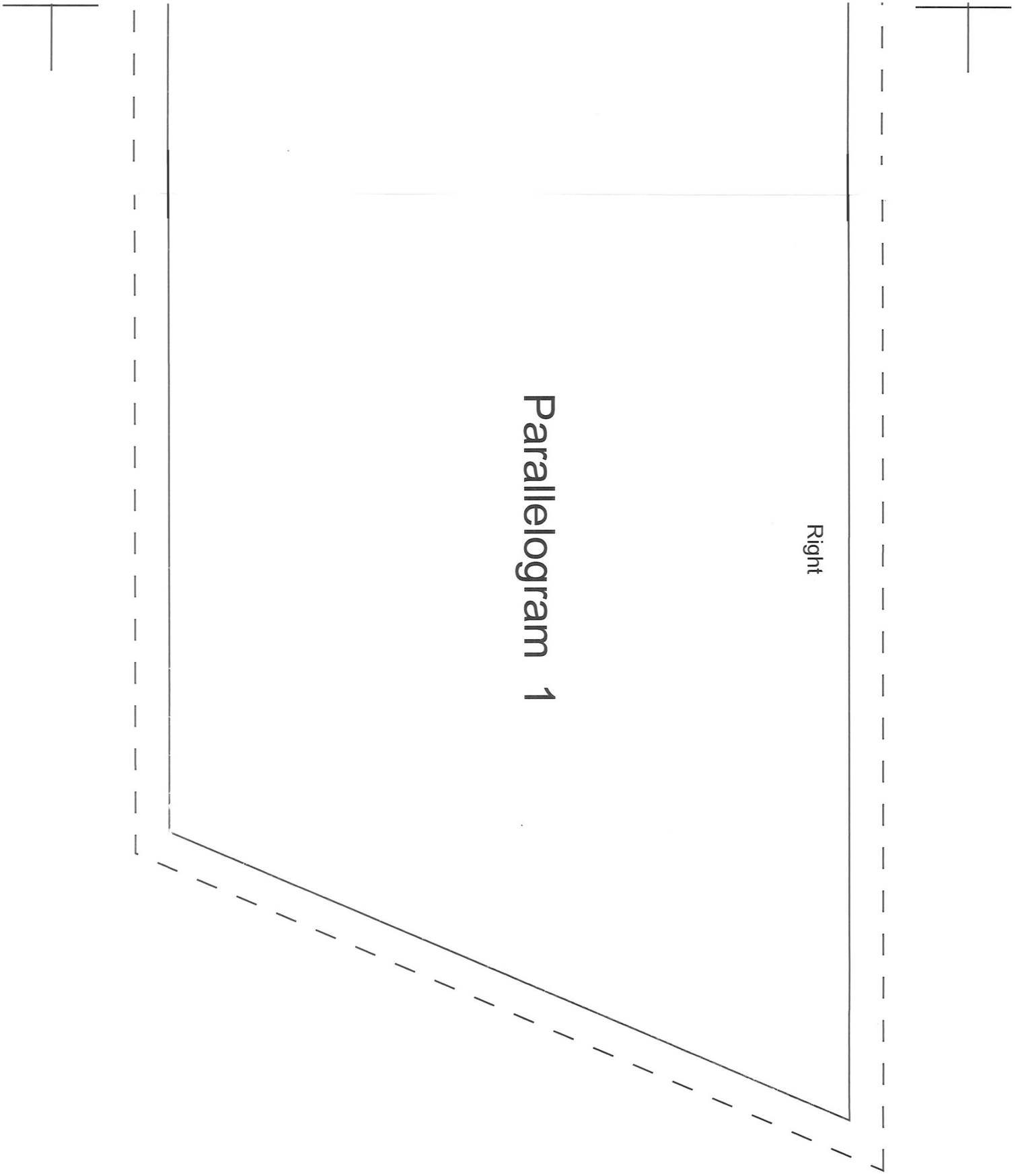

Print out template and piece together for actual size. Line up halves to complete parallelogram 1 and parallelogram 2.

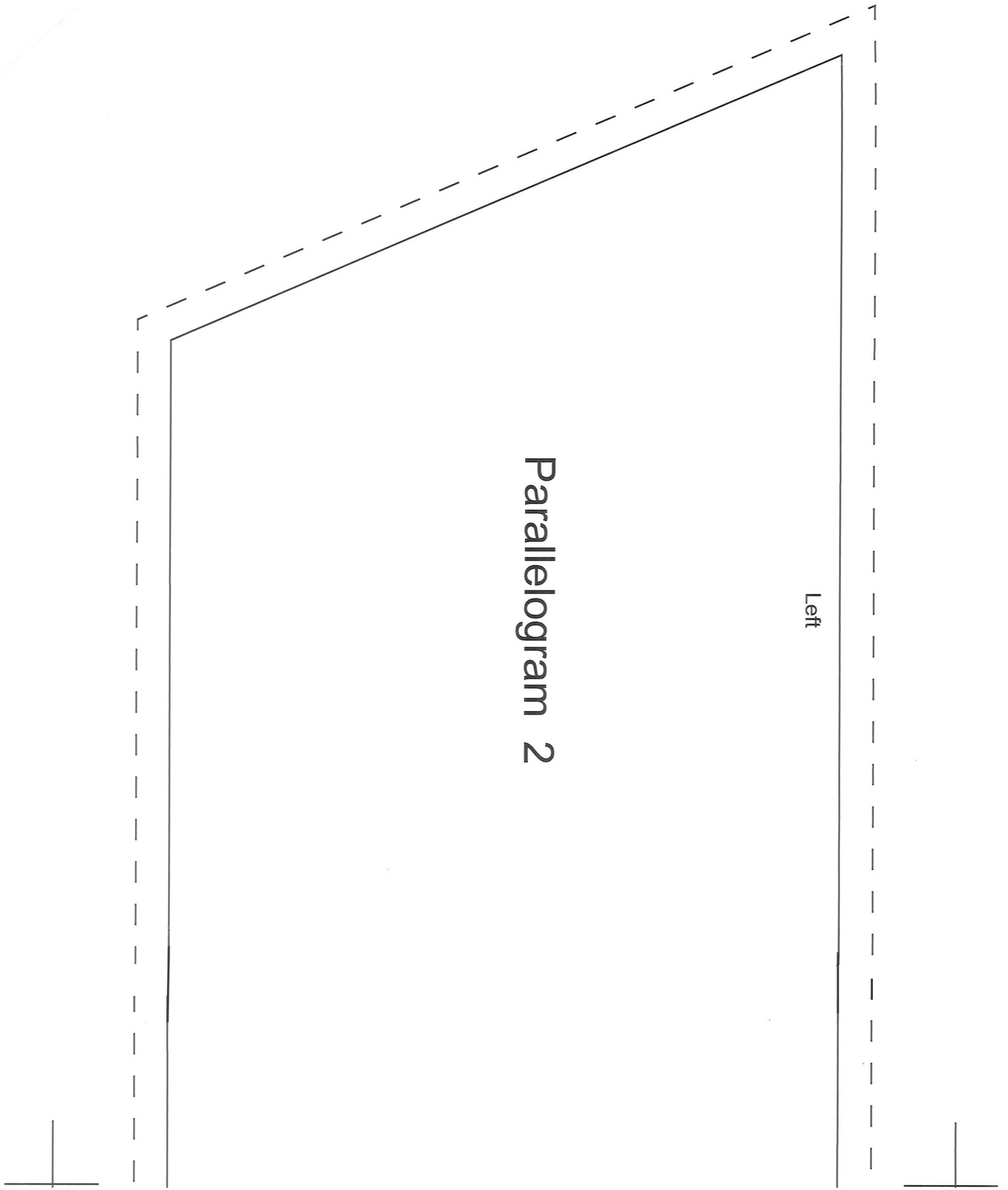

Print out template and piece together for actual size. Line up halves to complete parallelogram 1 and parallelogram 2.

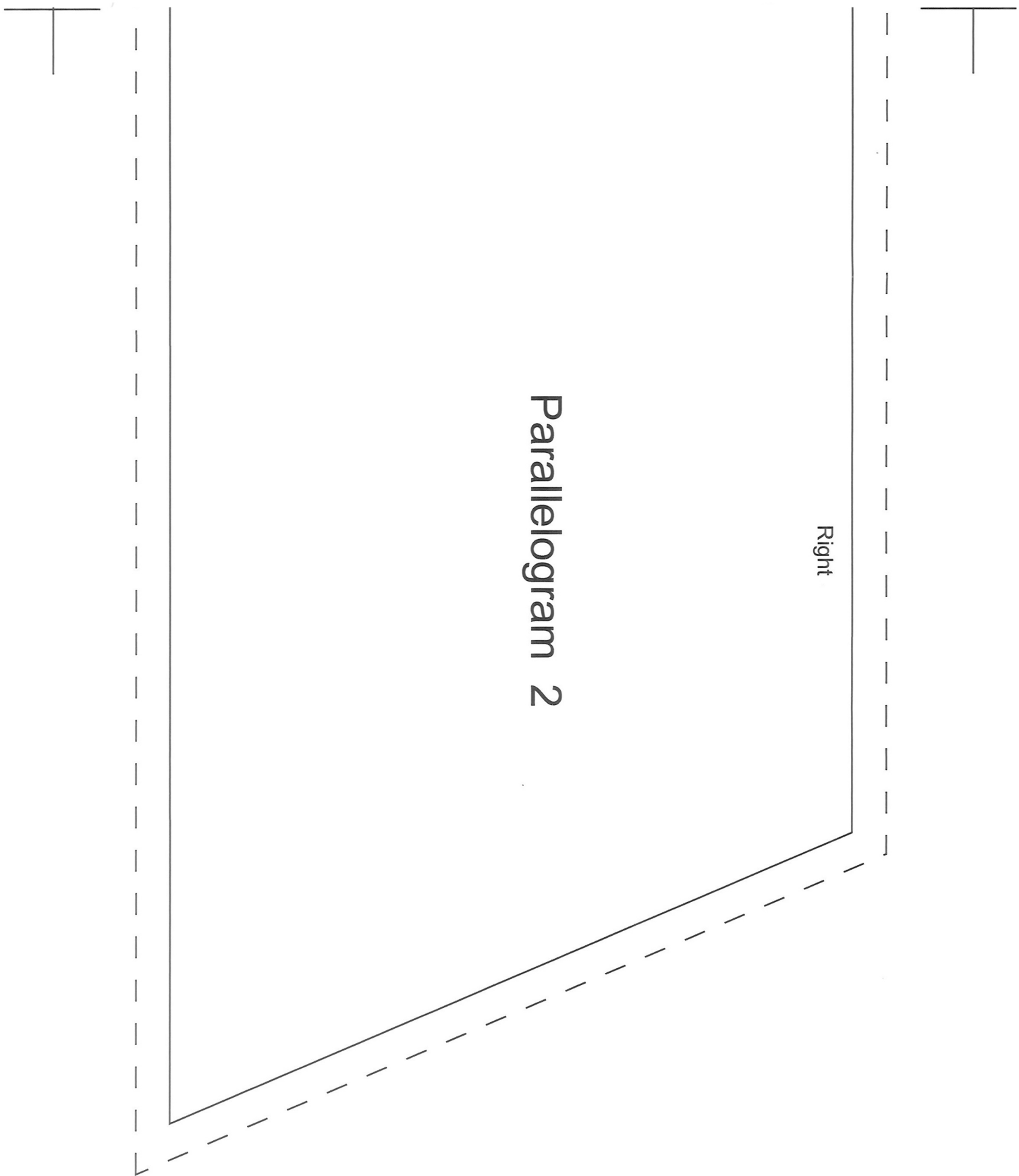

Print out template and piece together for actual size. Line up halves to complete parallelogram 1 and parallelogram 2.